

TE 541 3D FVZ

for unrebated residential and heavy-duty doors with recessed frame facings

hinge

Technical details

load capacity	100,0 kg
overall length	185,0 mm
width (door)	28,0/32,0 mm
width (frame)	28,0/33,0 mm
cutter diameter	24,0 mm
opening angle	180° degree

descriptive text

SIMONSWERK TECTUS hinge TE 541 3D for recessed frame facings (FVZ) up to 14,0 mm. Completely concealed for unrebated doors with timber, steel and aluminium frames. With comfortable 3D adjustment, load capacity up to 100 kg, opening angle up to 180°, overall length 185 mm, right hand and left hand applicable, maintenance-free slide bearings, three-dimensionally adjustable: side +/- 3,0 mm, height +/- 3,0 mm, compression +/- 1,0 mm. Finish...

Note

The load capacity mentioned above refers to the use of 2 hinges per door leaf (1 x 2 m).

Finger protection on the hinge side due to a small gap between door and frame.

Product features

- completely concealed hinge system
- for timber, steel or aluminium frames
- for unrebated heavy-duty doors
- maintenance-free slide bearings
- with comfortable 3D adjustment (side +/- 3,0 mm, height +/- 3,0 mm, compression +/- 1,0 mm)
- for recessed frame facings (FVZ) up to 14,0 mm

installation tools

universal milling frame	
template 5 250682 5	frame, step 3
template 5 250942 5	frame / door, step 1
template 5 250943 5	frame / door, step 2
template 5 250944 5	door, step 3

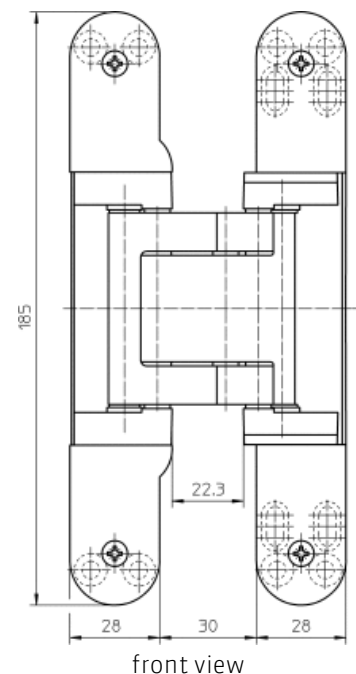

TE 541 3D FVZ

for unrebated residential and heavy-duty doors with recessed frame facings

hinge	
-------	--

Items (DIN reference: DIN right and left hand)

finishes(es)	F1-coloured 124
packing unit	pack of 2
item number	5 400631 0 12402
finishes(es)	stainless steel look 126
packing unit	pack of 2
item number	5 400631 0 12602

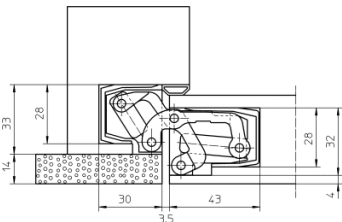

recessed frame facings

While every due care has been taken, we cannot be held responsible for errors, omissions or defects.
We kindly ask for your understanding.