

SIMONSWERK

VARIANT® VX

VX 7729/160 18-3

for unrebated heavy-duty doors

hinge

Technical details

load capacity	160,0 kg
knuckle length	160,0 mm
knuckle diameter	18,0 mm
material thickness	3,0 mm
cutter diameter	24,0 mm
screws	5,0x50,0 mm

descriptive text

SIMONSWERK VARIANT heavy duty hinge VX 7729/160 18-3 for unrebated doors with timber, steel or aluminium frames with three-dimensionally adjustable SIMONSWERK receivers VARIANT VX. CE-certified, load capacity 160 kg, knuckle length 160 mm, knuckle diameter 18 mm, right hand and left hand applicable. Internal torsion-proof pin, concealed, maintenance-free, generously dimensioned axial-radial slide bearings. Finish...

Note

The load capacity mentioned above refers to the use of 2 hinges per door leaf (1 x 2 m).

A reinforcing dowel 12x50 mm per hinge is recommended when the door is subject to heavy usage.

Product features

- for unrebated heavy-duty doors
- for timber, steel or aluminium frames
- for 3D adjustable VARIANT VX receivers
- internal pin
- concealed, maintenance-free axial-radial slide bearings
- integral security pin

Functional areas

fire resistance, smoke resistance

Quality marks



Combination

receiver

VX 2501 3D
VX 7501 3D
VX 2502 3D
VX 7502 3D

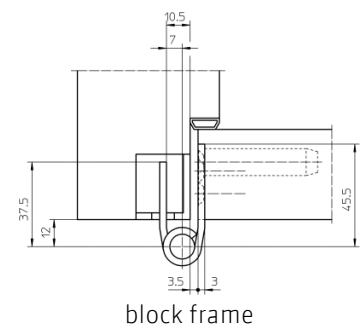
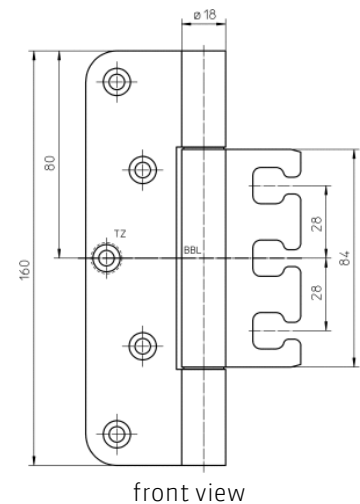
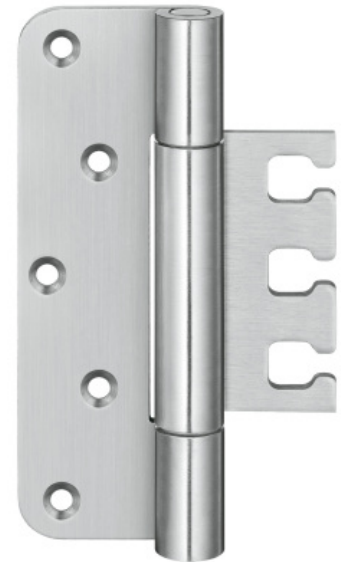

VX 7729/160 18-3
for unrebated heavy-duty doors

hinge	
-------	--

Combination	VX 7506 3D VX 2505 3D VX 7505 3D VX 7611 3D VX 7612 3D VX 7521 3D
-------------	----------------------------------------------------------------------------------

installation tools	
universal milling frame	
template 5 250353 5	

Items (DIN reference: DIN right and left hand)	
finishes(es)	satin brushed stainless steel 040
packing unit	pack of 20
item number	5 051870 0 04007

While every due care has been taken, we cannot be held responsible for errors, omissions or defects.
We kindly ask for your understanding.