



## Shelf White Edition 802.03.W110L

- chrome-plated mirror shelf with all-round edging and firmly fitted, breakproof synthetic shelf
- used for support, to stand up independently and to hold accessories
- with integrated support rail
- support rail tilt adjustable in positions 0° and 30°
- easy and enclosed assembly with the included corrosion-free HEWI fixing material
- easy to clean surface
- version left
- 434 mm wide, 220 mm high, 151 mm deep
- shelf surface in matt white synthetic material
- frame in chrome-plated aluminium with powder coated, white features
- grip in tactile polyamide in the HEWI colour 98 (signal white) and 99 (pure white)



### Dimensions in mm

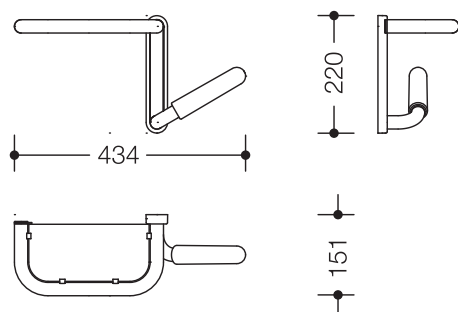

#### Surfaces/Colour

chrome	white	98	99
--------	-------	----	----

#### LifeSystem White Edition

#### Alternative surfaces/colours

chrome	matt	33	92	97	98	99
--------	------	----	----	----	----	----

#### LifeSystem

Technical information subject to alteration, 16.01.2013

HEWI Heinrich Wilke GmbH  
Postfach 1260  
D-34442 Bad Arolsen

Telefon: +49 5691 82-366  
Telefax: +49 5691 82-99366  
international@hewi.com  
www.hewi.com

HEWI (UK) Limited  
Scimitar Close  
Gillingham Business Park  
Gillingham Kent ME8 0RM

Phone +44 1634 377 688  
Fax + 44 1634 370612  
info@hewi.co.uk  
www.hewi.co.uk