

Product data sheet

HEWI active+ Removable hanging seat 801.51D110

HEWI



Similar picture

HEWI active+ Removable hanging seat 801.51D110

- made of rails, seat and back slats
- with continuous, corrosion resistant steel core
- used as a removable seat in the shower area
- maximum weight capacity 150 kg
- for hanging on shower grab rails and support rails, rail diameter 33 mm
- 448 mm wide, 395 mm high, 500 mm deep, seat 448 mm wide, 352 mm deep, seat slats 60 mm wide
- made of high-quality polyamide in HEWI colour 98 (signal white), with active antimicrobial microsilver



HEWI active⁺

Dimensions in mm

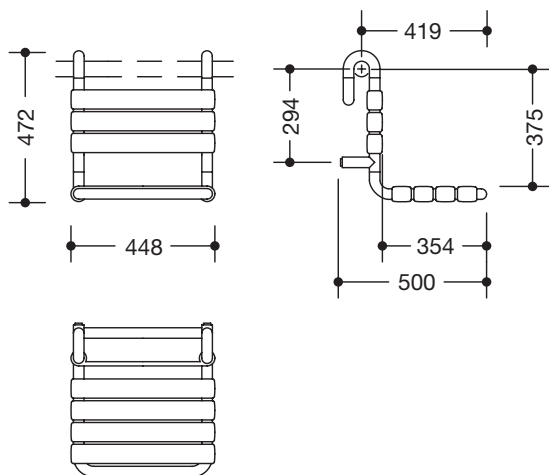

Colour

98

Technical information subject to alteration, 16th August 2019

HEWI Heinrich Wilke GmbH
Postfach 1260
D-34442 Bad Arolsen

Telefon: +49 5691 82-366
Telefax: +49 5691 82-99366
international@hewi.com
www.hewi.com

HEWI (UK) Limited
Holm Oak Barn, Beluncle Halt
Stoke Road
Hoo Kent ME3 9NT

Phone +44 1634 258 200
Fax +44 1634 250 099
info@hewi.co.uk
www.hewi.com